

# INFRASTRUCTURE

# PRISONS

# REDEVELOPMENT

# PROGRAM



Tasmania

## INFORMATION SHEET 6 Prisons Infrastructure Redevelopment Program (PIRP)

December 2003

### Development Application approved

The Development Application for the new Prison facilities, Correctional Health Centre and Secure Mental Health Unit on the Risdon Vale site has been approved by the Clarence City Council. This paves the way for the project to proceed to detailed design work.

### Parliamentary Standing Committee on Public Works approval

The Parliamentary Standing Committee on Public Works has given its approval for the Project to proceed.

### Appointment of a Managing Contractor

The tender process has been completed. The contract has been awarded to the John Holland-Fairbrother Joint Venture. For the next few months the Managing Contractor will work with the design consultants, the Prison Service, the Correctional Health Service, the Forensic Mental Health Service and other stakeholders to produce detailed designs and a staging process for the building works.

### Detailed design work

The completion of a detailed design for each of the facilities will take place from early November to the end of February 2004. This will build upon the earlier schematic or overall designs.

### Timing for construction of the new Prison facilities

Building of the new prison facilities on the existing site at Risdon Vale is scheduled to start in late May or early June 2004. Prior to the commencement of the building work there will be some preparation activity at the site. This will include earth-moving. It will start in January 2004.

The new Men's Prison (maximum and medium security) will be completed by mid-way through 2006. The new Women's Prison (including redevelopment of some existing facilities) will be completed by early 2006. Subsequent alterations to the existing Risdon Maximum Prison, to convert it to a lower-security facility (Risdon Minimum), will be completed by mid-2007.

Right: Royce Fairbrother,  
Director, Fairbrother Pty Ltd



Left: Michael King, Project  
Manager, of  
John Holland  
Pty Ltd, and  
Bob Bennetto,  
General  
Manager

# INFRASTRUCTURE PRISONS REDEVELOPMENT PROGRAM

## Landscape work

Some early tree and shrub planting took place in 2002 around the edge of the site. An overall landscape design has now been completed for the perimeter of the complex and the rejuvenation of the creek area. Local residents may have noticed some further landscaping activity going on recently. A further 5500 bushland seedlings are being planted. The contract for the perimeter planting was awarded to Greening Australia. There is a significant level of involvement from prisoners in landscaping and maintenance work.

More seedlings will be planted next autumn, winter and spring. This early planting approach will enable the trees to reach maturity and provide privacy and screening as early as possible. Local residents have also been involved in the project helping to plant out areas of the site. If you would like to be involved in planting or helping to maintain the trees and shrubs please contact the PIRP office on the number listed below.

## Artwork to be incorporated into the new buildings

As the Project is funded under the Capital Investment Program (CIP) the Prisons Infrastructure Redevelopment Program will incorporate specifically commissioned artwork as part of The Art for Public Buildings Scheme. This will result in \$40,000 worth of public artwork being incorporated into the new facilities.

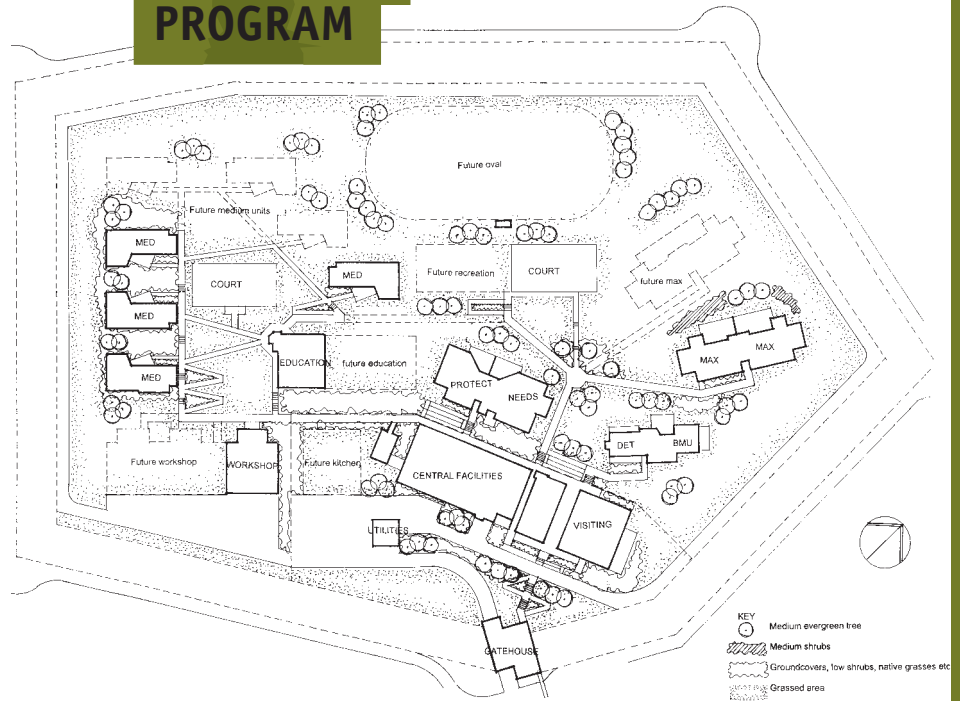

## Social history of the Prison

Dr Caroline Evans has been commissioned to provide a social history of imprisonment at Risdon and place it in the context of Tasmania's penal history. The history project is being developed as part of the Bicentenary celebrations. It will also be developed into an information package for use in schools as well as a moveable display to be used in the Tasmanian Bicentennial Exhibition in 2004.

If you would like to contribute to the social history project please email Caroline or contact either Janine Combes or Sally Barker, the consultants working with stakeholder groups (see the contact details below).

## Recording the buildings and structures prior to demolition

A Heritage Archaeologist, Mr Paul Davies, has been commissioned to develop a record of all buildings

and structures at the Prison site that will be demolished or significantly altered during this stage of the construction.

For further information about the Prison Infrastructure Redevelopment Program (PIRP) contact:

Phone: 03 6233 4758

[pirp@justice.tas.gov.au](mailto:pirp@justice.tas.gov.au)

[www.justice.tas.gov.au/pirp/index.htm](http://www.justice.tas.gov.au/pirp/index.htm)

## COMMUNITY AND STAKEHOLDER INPUT:

Janine Combes: 03 6224 9579

[jcombes@trump.net.au](mailto:jcombes@trump.net.au)

Sally Barker: 0417 083061

[sallybarker60@yahoo.com.au](mailto:sallybarker60@yahoo.com.au)

## SOCIAL HISTORY PROJECT:

[Caroline.Evans@utas.edu.au](mailto:Caroline.Evans@utas.edu.au)

## **PRISON SERVICE UPDATE: Preparing for the move to the new prison facilities**

### **Prison Service Organisation Development Program**

The Prison Service is involved in extensive preparation work to support the move to the new and upgraded facilities. This work is part of the Organisation Development Program which is now being managed by Ginna Webster. The preparation work involves the development of a new custodial operating model, an extensive transition plan to prepare for the move and a comprehensive human resource strategy for the organisation in the future.

Sandi Trajdos, formerly Director of Community Corrections, has been appointed Principal Consultant to the Organisation Development Program and will manage specific projects including the development of the operating model and transition plan.

Several projects have already commenced as part of the program. These include a review of the Prison Service roster system and a transition plan for decommissioning Ron Barwick Medium Security Prison. Additionally a member of the Tasmanian Custodial Officer Association Executive has been seconded to work on the development of a structured day for Risdon Prison.



### **Decommissioning and redevelopment of existing prison facilities**

The existing Ron Barwick men's medium security facility at Risdon will be decommissioned in January 2004 in preparation for the building work. Prisoners within Ron Barwick will be transferred to other facilities. Preparation work is underway to increase the capacity of Hayes Prison Farm so that it can accommodate more prisoners.

Longer-term decisions about the future location of minimum security prisoner facilities will be considered by the Government by the end of this current building program.

There will be a gradual process of re-development of other facilities (e.g. the Women's Prison, staff training facilities) during the building program.

For further information about the transition to the new operating model for THE PRISON SERVICE please contact:

Graeme Barber  
Director of Prisons

Phone: 03 6216 8180



Tasmania

DEPARTMENT of  
HEALTH and  
HUMAN SERVICES

## The new Correctional Health Centre and Secure Mental Health Unit

### THE SECURE MENTAL HEALTH UNIT

#### Site preparation work

Excavation work on the Risdon Vale site for the new Secure Mental Health Unit (SMHU) will begin in January 2004. It will be operational in 2005. It will be owned and operated by the Department of Health and Human Services (Forensic Mental Health Service). The Unit will be officially named in 2004. While the Secure Mental Health Unit will be located on the prison site at Risdon Vale it will be physically and operationally separate from the Prison.

#### Development of a new operating model and transition plan

Work is progressing on the development of a new operating model for the Secure Mental Health Unit as well as a transition plan to support the move to the new facility when it is completed.

#### Appointment of a Project Manager

Victoria Henderson has been appointed as the Project Manager to develop the operating model and manage the transition to the SMHU.

#### Displays at Mental Health Week

Displays about the new Secure Mental Health Unit were held at several events round the State recently as part of Mental Health Week. There was considerable interest in the new facility.

### Information sheet

An information sheet about the Secure Mental Health Unit has been produced. This provides detailed information about who is to be admitted to the facility, the legislation governing admission and the different levels of care that will be offered. For further information please phone Joanne Keil (see the contact details listed below).

#### Design process

A schematic or overall design has been developed for the Secure Mental Health Unit. The next stage will involve the detailed design (including fit-out) of each room or area. This process will continue, in consultation with internal and external groups, over the next three months.

### THE CORRECTIONAL HEALTH CENTRE

The existing Prison Hospital will be replaced by two new facilities through the PIRP construction project:

- a Secure Mental Health Unit for those with severe mental health issues (run by the Department of Health and Human Services but co-located on the site at Risdon Vale); and
- a Correctional Health Centre which will provide general outpatient care to prisoners as well as some in-patient beds. This facility will be part of the new Maximum/Medium Men's Prison. It will also provide health services to women prisoners through an outreach

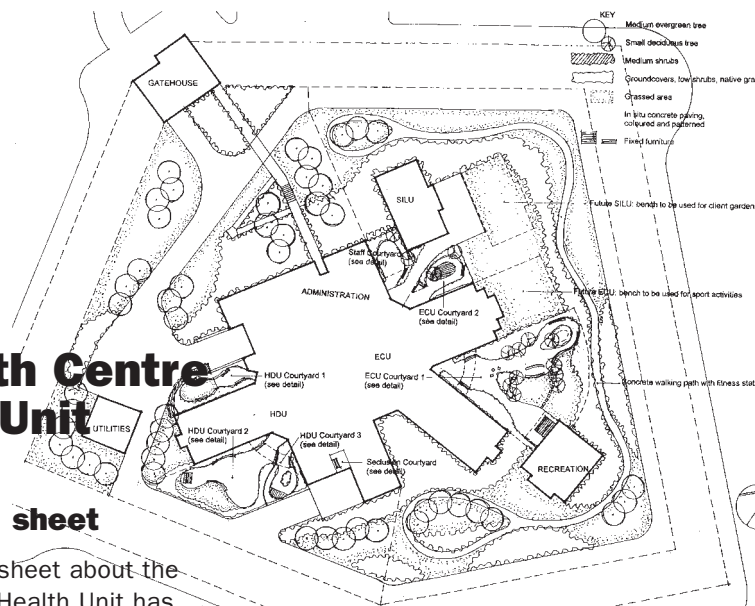

service to a dedicated area located within the Women's Prison. Outreach services will also be provided to male, minimum security prisoners within the converted Risdon Minimum Prison.

Work on the new Correctional Health Centre will begin during the main prison building program. Over the coming months detailed design work will also be carried out for the Correctional Health Centre.

If you would like further information about the new CORRECTIONAL HEALTH CENTRE please contact:

Joanne Keil

Correctional Health Liaison Officer  
Prisons Infrastructure  
Redevelopment Program  
Department of Justice and  
Industrial Relations  
Phone: 03 6233 7649

[Joanne.keil@justice.tas.gov.au](mailto:Joanne.keil@justice.tas.gov.au)

If you would like more information about the SECURE MENTAL HEALTH UNIT please contact:

Victoria Henderson

Project Manager  
The Secure Mental Health Unit  
Department of Health and Human  
Services  
Phone: 03 6230 7800

[victoria.henderson@dhhs.tas.gov.au](mailto:victoria.henderson@dhhs.tas.gov.au)